

# M&R

CRANES & HOISTS

迈德锐起重泰州有限公司

# MAGNETIC MACHINE

专注永磁起重产品

SINCE 2012

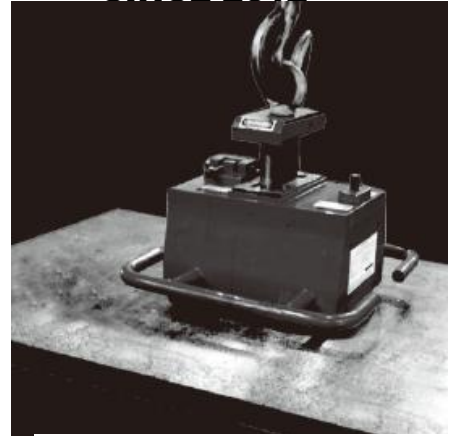

## M&R CRANES

迈德锐起重

M&R CRANES & HOISTS CO., LTD.  
98 Renmin South Road,  
Jingjiang, Taizhou, Jiangsu, China

迈德锐起重泰州有限公司  
江苏省靖江市人民路 98#  
邮编: 200331

www.moris.cn  
P 电话 : +86.523.88900900  
F 传真 : +86.523.88900902



## 最新自动系列

### Newest Automatic Permanent Magnetic Lifter Series

HB 系列是我公司自主研发推出的一款最新型永磁自动起重吸盘，操作更简单、磁力更精准，启动行程短，是原自动系列的创新版本。其优势特点：1) 多轴一致启动无链条齿轮链接，一致性更强更精确 2) 无摆臂推动装置，采用直驱方式，稳定性极佳 3) 安装新型“可视变化”开关装置，吸持和释放、一目了然。

HB series is a newest automatic permanent magnetic lifter series which independent research and development by our company, operation more simple and accurate, it is the innovation of original HC series. Its features: 1) multi-axis line start the gear chain links, consistency is more strong and precision; 2) without swing arm push device, adopting direct-drive mode, the stability is excellent; 3) installing the new "visual change" switch device, suck and release, be clear at a glance.

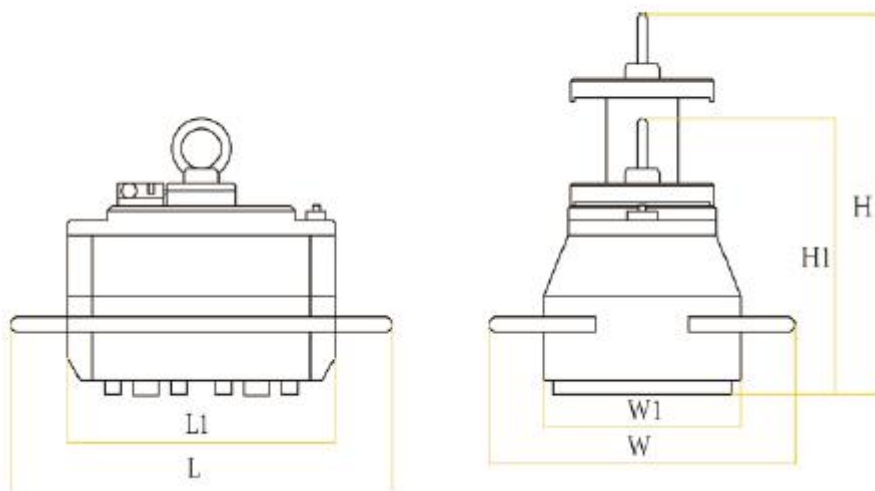

HB自动吸盘系列 × 尺寸表

型号 MODEL	长L L(mm)	长L1 L1(mm)	宽W W(mm)	宽W1 W1(mm)	高H H(mm)	高H1 H1(mm)	自重 Weight(kg)	最大托力 Pull off force(kg)
HB-1	460	330	400	240	430	340	110	3500
HB-2	485	335	510	360	586	448	220	7000
HB-3	505	355	510	360	630	480	280	9000
HB-5	800	640	510	360	630	480	460	15000

HB自动吸盘系列 × 吊装钢板条件图

	钢材厚度 (Steel plate thickness)		负载能力之比例 (Rate of hoisting capacity)					
	mm	inch	HB-30	HB-20	HB-10	HB-6	HB-4	HB-1
T1	Up60	Up2.36	100%	100%	100%	100%	100%	100%
T2	55	2.16"	95%					
T3	50	1.97"	90%	95%				
T4	45	1.77"	85%	90%				
T5	40	1.57"	80%	85%	90%	90%	90%	
T6	35	1.38"	70%	75%				
T7	30	1.18"	60%	66%	80%	90%	90%	90%
T8	25	0.98"	50%	55%	70%			
T9	20	0.79"	40%	45%	60%	75%	90%	90%
T10	15	0.59"	30%	35%	50%	60%	70%	70%
T11	10	0.39"	20%	25%	35%	45%	50%	70%
T12	5	0.20"	10%	15%	20%	25%	30%	40%

HB自动吸盘系列 × 吊装材质条件图

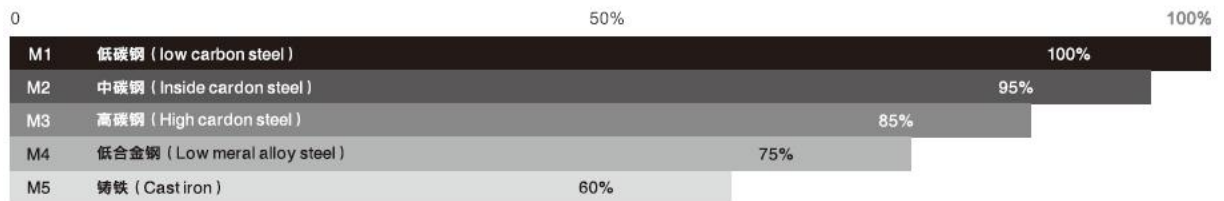

HB-1 到 HB-2 型号吊装曲线图

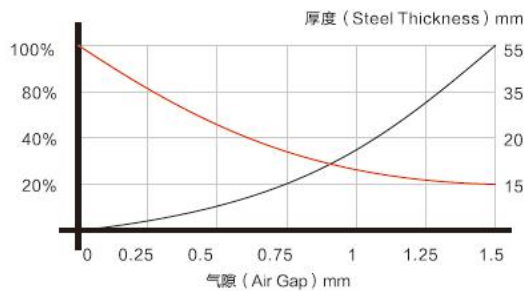

HB-3 到 HB-5 型号吊装曲线图

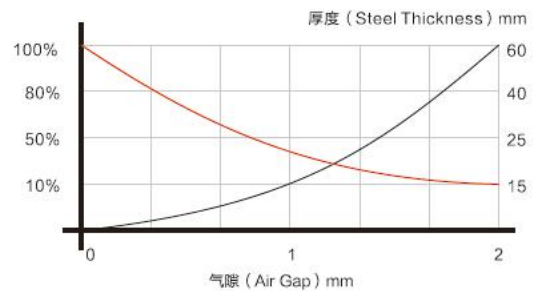



## HC自动吸盘系列

Hc Automatic Permanent Magnetic Lifter Series

# 永磁自动吸盘

## Automatic Permanent Magnetic Lifter

HC 系列起重器无需电源即可自动循环完成吸持和释放工件动作，操作简单方便，使用安全可靠，广泛使用于机械制造业、造船厂等。既可单台使用，又可多台组合吸运大型长条钢板，钢坯或其它型钢，使用寿命长，是一种节约能源的理想吊装设备。

HC series can complete suck and release of automatic cycle by itself without electric supply, which operating simple, using safe and reliable. It is wildly used in molding, mechanism manufacturing and dockyard. It can be used single, or combine for large and long steel plate, steel billet or other steel. It has long useful life, and it is an ideal lifting equipment of saving energy.

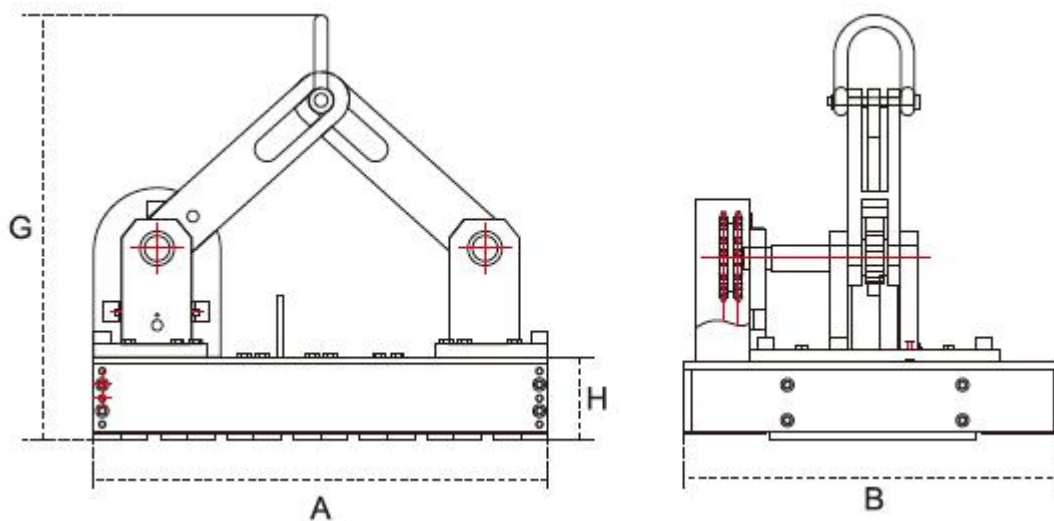

HC自动吸盘系列 × 尺寸表

型号 MODEL	额定起重能力 Fixed power(kg)	最大拉托力 Max power(mm)	长度A A(mm)	长度B B(mm)	底座高度H H(mm)	伸长高度G G(mm)	重量 Weight(kg)
HC-1	1000	3500	595	435	110	580	230
HC-2	2000	7000	720	580	120	700	320
HC-3	3000	9000	790	580	120	750	380
HC-5	5000	15000	998	790	135	960	620

HC自动吸盘系列 × 吊装钢板条件图

	钢材厚度 (Steel plate thickness)		负载能力之比例 (Rate of hoisting capacity)					
	mm	Inch	HC-30	HC-20	HC-10	HC-6	HC-4	HC-1
T1	Up60	Up2.36	100%	100%	100%	100%	100%	100%
T2	55	2.16"	95%					
T3	50	1.97"	90%					
T4	45	1.77"	85%					
T5	40	1.57"	80%	85%	90%	90%	90%	
T6	35	1.38"	70%	75%				
T7	30	1.18"	60%	66%	80%	90%	90%	90%
T8	25	0.98"	50%	55%	70%			
T9	20	0.79"	40%	45%	60%	75%	90%	90%
T10	15	0.59"	30%	35%	50%	60%	70%	70%
T11	10	0.39"	20%	25%	35%	45%	50%	70%
T12	5	0.20"	10%	15%	20%	25%	30%	40%

HC自动吸盘系列 × 吊装材质条件图

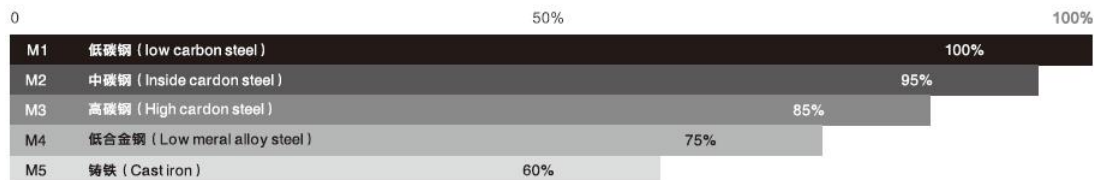

HC-1 到 HC-2 型号吊装曲线图

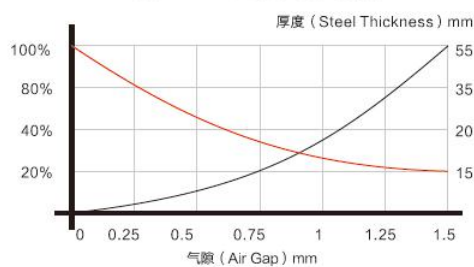

HC-3 到 HC-5 型号吊装曲线图

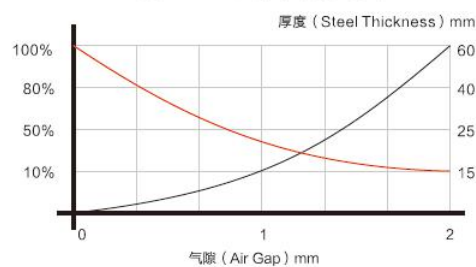





## HD系列

# 永磁起重器/磁力吊

## Manual Permanent Magnetic Lifter

永磁起重器/磁力吊采用高性能永磁材料钕铁硼 (Nd-Fe-B) 为内核, 使体积更小, 起重吊装力更强, 磁力恒久不衰。独特磁路设计, 使剩磁几乎为零。安全系数高, 最大拉脱力是额定起重力的3.5倍。手柄开关附有安全钮, 可单手操作, 安全方便。起重器底面有“V”型槽, 可起吊相对应的圆钢、钢板。

Use high-performance permanent-magnet materials Nd-Fe-B as the core, which makes it be smaller and stronger magnetism, magnetic power is stable forever. Remanence is almost zero with optimize-designed magnetism distribution. High safe coefficient, the biggest lifting capability is 3.5 times of rated. Handle switch with safety button, can operation by one hand, safe and convenient. The "V" design on subface makes it easier to lift up round and flat steel.

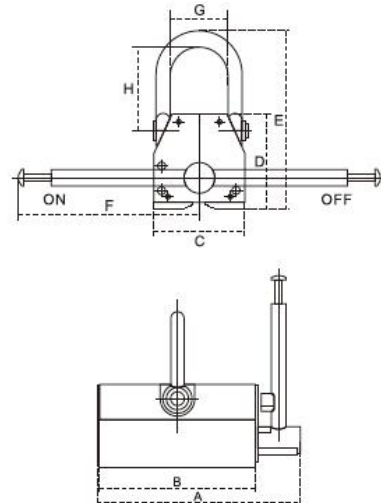

HD自动吸盘系列 × 尺寸表

型号 Model	额定起重能力 Fixed power		外形尺寸 Size								最大拉托力 Pull off force	重量 Weight
	钢板 Steel plate	圆形钢材 Round steel	A	B	C	D	E	F	G	H		
	kg	kg	mm	mm	mm	mm	mm	mm	mm	mm	kg	kg
HD-1	100	50	95	85	77	80	140	155	30	68	350	3.5
HD-3	300	150	180	175	86	85	130	185	53	52	1050	11.5
HD-4	400	200	201	196	110	110	200	210	69	102	1400	18.2
HD-6	600	300	221	217	115	125	217	235	69	102	2100	25
HD-10	1000	500	295	291	142	140	270	265	82	140	3500	45
HD-15	1500	750	313	352	145	152	280	350	100	134	5000	55
HD-20	2000	1000	360	350	165	175	290	426	100	134	6000	80
HD-30	3000	1500	460	450	180	186	300	520	100	134	9000	100
HD-50	5000	2500	550	590	235	235	340	650	105	230	15000	240

## CRANES & HOISTS

HD自动吸盘系列 × 吊装钢板条件图

	钢材厚度 (Steel plate thickness)		负载能力之比例 (Rate of hoisting capacity)					
	mm	inch	HD-30	HD-20	HD-10	HD-6	HD-4	HD-1
T1	Up60	Up2.36	100%	100%	100%	100%	100%	100%
T2	55	2.16"	95%	95%				
T3	50	1.97"	90%	95%	100%	100%	100%	100%
T4	45	1.77"	85%	90%				
T5	40	1.57"	80%	85%	90%	100%	100%	100%
T6	35	1.38"	70%	75%				
T7	30	1.18"	60%	66%	80%	90%	100%	100%
T8	25	0.98"	50%	55%	70%			
T9	20	0.79"	40%	45%	60%	75%	90%	100%
T10	15	0.59"	30%	35%	50%	60%	70%	
T11	10	0.39"	20%	25%	35%	45%	50%	70%
T12	5	0.20"	10%	15%	20%	25%	30%	40%

HD自动吸盘系列 × 吊装材质条件图

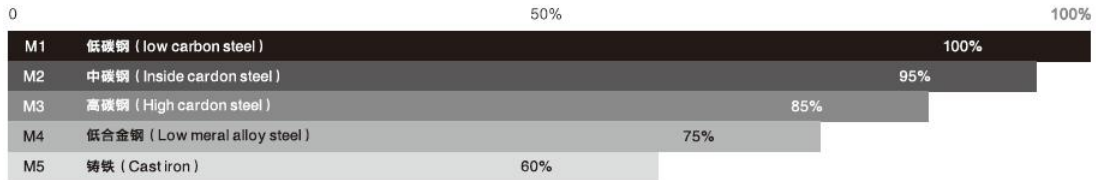

HD-1 到 HD-2 型号吊装曲线图

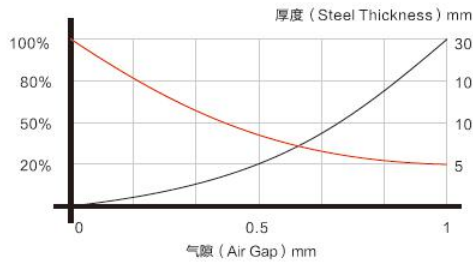

HD-3 到 HD-8 型号吊装曲线图

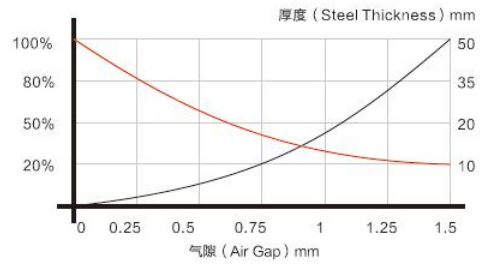

HD-10 到 HD-20 型号吊装曲线图

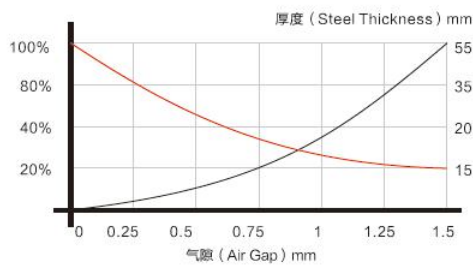

HD-30 到 HD-50 型号吊装曲线图

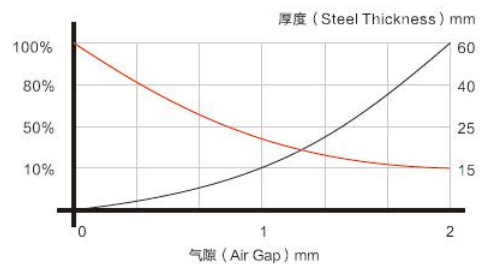



PML系列

## 永磁起重器/磁力吊

### Manual Permanent Magnetic Lifter

采用钕铁硼为内核,体积更小,自重更轻,吸力更大。优化的磁路设计,剩磁几乎为零,并具备3.5倍的安全系数。"v"型槽设计的起重底面,可起吊相对应的圆钢、钢板。磁力恒久不衰,使用安全可靠。可在野外操作,广泛应用于钢材的起吊搬运,平整机械零件以及各种磨具的安装搬运。

Use Nd-Fe-B as the core, which makes it small volume, light weight and strong magnetism. Remanence is almost zero with optimize-designed magnetism distribution, and the safe coefficient of lifter is 3.5 times. The "V" design on subface makes it easier to lift up round and flat steel. Magnetism keep permanent, safe and convenient. It can operation in the field, and widely used to lift and transport the steel and iron for factories.

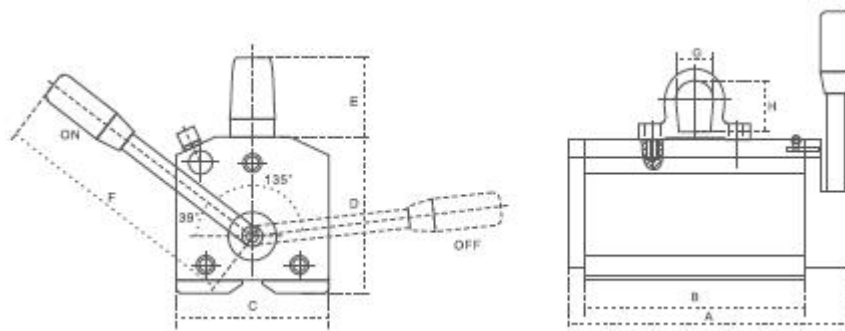

PML自动吸盘系列×尺寸表

型号 MODEL	额定起重能力 Fixed power (kg)	A mm	B mm	C mm	D mm	E mm	F mm	G mm	H mm	重量 Weight (kg)
PML-300	300	211	174	81	83	77	200	40	55	11
PML-600	600	288	248	112	106	87	250	42	57	22
PML-1000	1000	338	293	148	131	96	280	52	60	43
PML-1500	1500	380	338	172	152	120	320	64	74	68
PML-2000	2000	425	410	180	160	120	380	64	74	90



## CRANES & HOISTS

PML自动吸盘系列 × 吊装钢板条件图

	钢材厚度 (Steel plate thickness)		负载能力之比例 (Rate of hoisting capacity)					
	mm	inch	PML-30	PML-20	PML-10	PML-6	PML-4	PML-1
T1	Up60	Up2.36	100%	100%	100%	100%	100%	100%
T2	55	2.16"	95%	95%				
T3	50	1.97"	90%	95%				
T4	45	1.77"	85%	90%				
T5	40	1.57"	80%	85%				
T6	35	1.38"	70%	75%	90%	90%	70%	
T7	30	1.18"	60%	66%	80%			
T8	25	0.98"	50%	55%	70%			
T9	20	0.79"	40%	45%	60%			
T10	15	0.59"	30%	35%	50%	60%	70%	70%
T11	10	0.39"	20%	25%	35%	45%	50%	
T12	5	0.20"	10%	15%	20%	25%	30%	

PML自动吸盘系列 × 吊装材质条件图

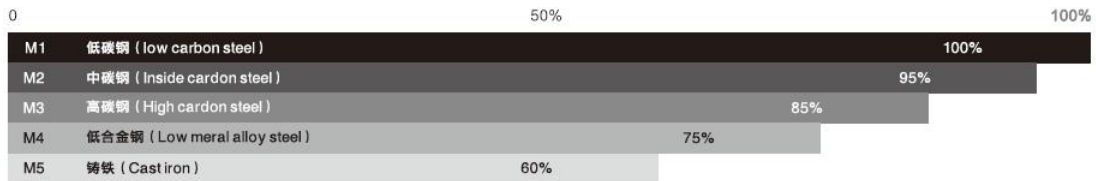

PML-1 到 PML-2 型号吊装曲线图

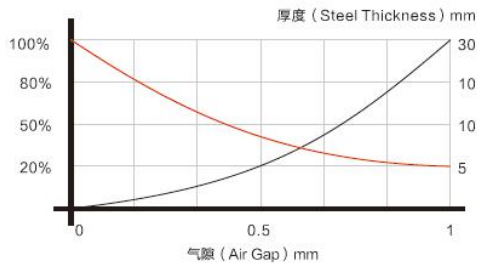

PML-3 到 PML-8 型号吊装曲线图

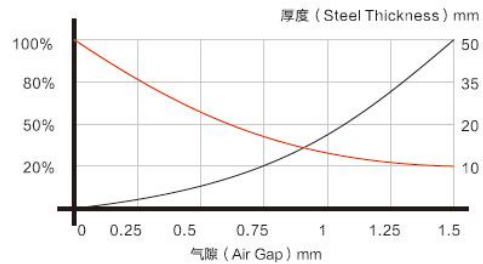

PML-10 到 PML-20 型号吊装曲线图

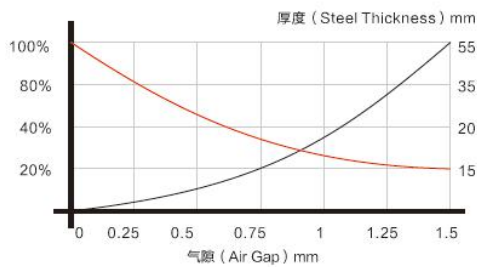

PML-30 到 PML-50 型号吊装曲线图

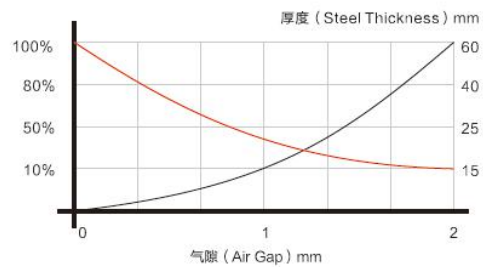

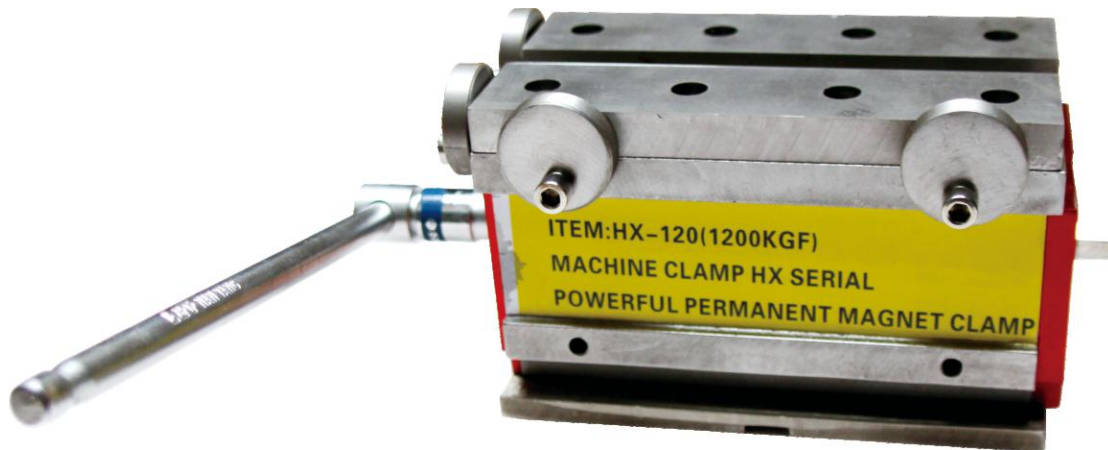

## HX夹具系列 Hx Permanent Magnetic Chuck Series

# 开关式永久磁力工作台

## Switch-typed Permanent Magnetic Clamping Block

新的工件夹持概念，适用于大型龙门铣床立式及卧式CNC综合切削加工机及铣床，适用于大中型工件加工，快速夹持工件，可做5面切削加工，钻孔、攻牙、铣沟槽一次完成，节省加工流程以降低过多加工程序之重覆公差，并提高工作效率，大幅降低加工成本。HX夹具系列可依工件之大小自由组合磁力工作台之数量、位置及间距，并附有替换式“导磁软爪”，其使用功能之多，可针对各种不同工件需求自行制作。

New concept of clamping way for mental working on CNC Machining Center and Milling Machine in clamping workpieces easily. It can complete 5 sides machining, drilling, tapping and milling groove for one time. The series can reduce repeat tolerances in machining procedures, raise work efficiency and greatly lower machining cost. And free to set up position, numbers and distance of magnetic clamping block according to the size of workpiece. The HX series including changeable "Induction Soft Block", the user can make it according to the requirement of workpiece by themselves as its Multi-function.

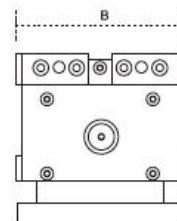
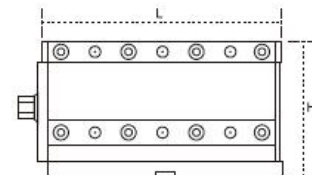

型号 MODEL	夹持吸力 CLAMP POWER	最小工件厚度要求 STICKNESS(min)	尺寸 SIZE (mm)			净重 WEIGHT (kg)
			L	B	H	
HX-50	500kgf	10mm	113	101	73.3	6
HX-75	1000kgf	10mm	216	115	93.3	18
HX-120	1500kgf	15mm	234	130	93.3	20
HX-210	2000kgf	25mm	275	132	93.3	26

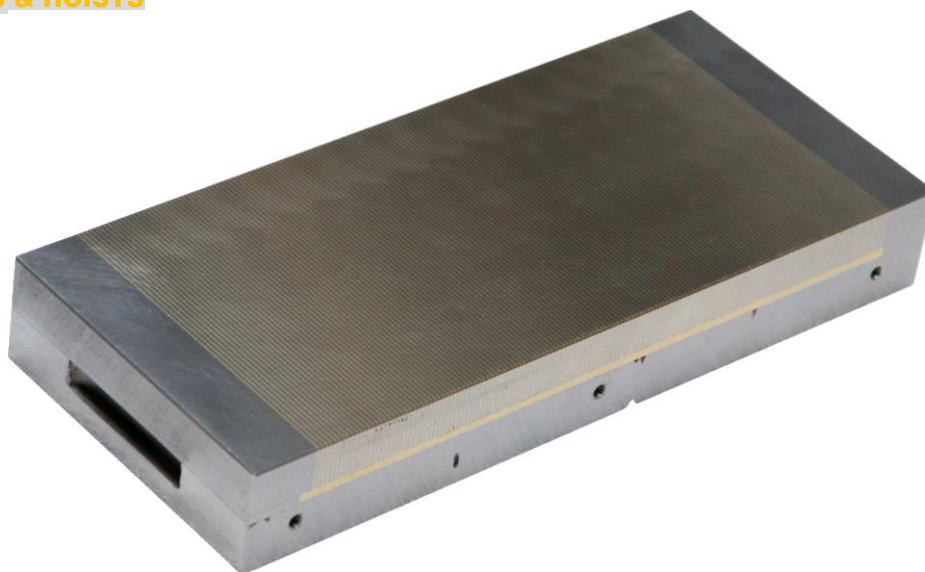

## HE系列

### He Clamp Series

适合于平面磨床，火花机，线切割机床。  
磁极间隙细密，磁力分布均匀，加工薄小工件时，效果明显。  
充、退磁时工作台面精密度无变化。  
面板经过特殊处理，无渗漏，可防止切削液腐蚀，延长磁盘使用寿命，可长时间放在切削液中工作。  
六面精磨加工，在线切割机床上可垂直使用。  
磁盘中使用高性能磁钢，吸力大，几乎无剩磁。

Applicable to surface grinding machine, spark machine, EDM. Finer Pole spacing, average magnetic uniform distribution and particularly obvious on thin small parts. Countertops accuracy unchanged when filling demagnetization. Panel with a special treatment, no residual leak, prevent cutting fluid corrosion, extend the useful life. 6 surface grinding process, the cutting machine bed can be used vertically. The use of high-performance disk-magnet, with large suction, almost no remanent magnetism.



66025	英制规格 British standard	型号 Model	主要尺寸 (mm) Dimension (mm)								净重 (kg) N.W(kg)
			A	B	C	D	E	F	G	I	
66025-2	4" x 7"	x M91 100 x 175	100	175	18	2.8 (1+1.8)	10	10	53	12	7
66025-4	5" x 16"	x M91 125 x 250	125	250	18	2.8 (1+1.8)	10	10	53	12	13
66025-6	6" x 6"	x M91 150 x 150	150	150	18	2.8 (1+1.8)	10	10	53	12	9.4
66025-8	6" x 12"	x M91 150 x 300	150	300	18	2.8 (1+1.8)	10	10	53	12	19
66025-10	6" x 14"	x M91 150 x 350	150	350	18	2.8 (1+1.8)	10	10	53	12	22
66025-12	6" x 16"	x M91 150 x 400	150	400	20	2.8 (1+1.8)	10	10	53	12	26
66025-14	6" x 18"	x M91 150 x 450	150	450	20	2.8 (1+1.8)	10	10	53	12	29
66025-16	8" x 16"	x M91 200 x 400	200	450	20	2.8 (1+1.8)	10	10	53	12	35
66025-18	8" x 18"	x M91 200 x 450	200	450	20	2.8 (1+1.8)	10	10	53	12	39
66025-20	8" x 20"	x M91 200 x 500	200	500	20	2.8 (1+1.8)	10	10	53	12	43





## HY系列

# 强力铣削用电永磁吸盘

## PERMANENT MAGNET ELECTRIC SUCTION

### 产品特点

- 灵活/低成本/高效
- 无需其他夹具，5面加工，操作步骤少。
- 使用安全，无内热，无变形。
- 整个平面平均夹紧，提高加工表面光洁度，提高刀具寿命，重复操作性强。
- 灵活的切削加工，可快速装夹，快速更换加工工件。对通孔加工清理方便，也可侧面夹持，角度切削。
- 自我调节的磁垫，可夹持和支撑不规则形状的工作件。
- 强大的夹持力，完全可以达到甚至超过切削所需夹持力。

### Features of Products

- Flexible, low-cost and high efficiency.
- Don't need other clamps, 5-sided machining and need few steps
- Average clamping force on surface to extend the useful life.
- Flexible machining, fast setup and rapid replacement of workpiece. Easy to clean and it can also be side clamp, angle cutting.
- Self-regulating magnetic pad, can clamp and support irregularly shaped workpieces.
- Powerful clamping force can be achieved even stronger than required clamping force.
- Clamping area is able to cover the full range of processing, which can process many workpieces to improve the process time.

### 用途及适用范围

- 适用于中小型工件以及粗糙工件之切削加工。
- 适用于小型工件之钻孔及精修加工。
- 工件厚度要求10毫米以上。
- 配合导磁软爪及滑动块使用，可得到更多加工功能，如：一次完成所有加工程序；不规则及表面弯曲之工件亦可夹持加工。

### Application of Products

- Applicable to small and medium sized parts and rough workpiece.
- Applicable to small parts of the drilling and intensive processing.
- The workpiece thickness require above 10mm.
- With the magnetic soft claws and sliding block, more features of the workpiece clamping process can be done.

### 各种磁垫的魅力

用螺栓固定在吸盘面上的那些简单碳钢块被叫做“磁垫”，可以将被加工件抬高以便进行钻通孔。断面铣削和背后加工。

这些“磁垫”也可以帮助吸盘进行侧面定位。可对细小工件进行侧面吸持。也可帮助对通孔加工的清理。对铣削加工非常奏效。

### The charm of different magnet

"magnetic pad" is fixed to the surface can lift workpieces to drill hole, mill face and back. These "magnetic pad" can help suction fixing, sucking up small pieces, and also clean-up the hole. It is very effective on the milling.

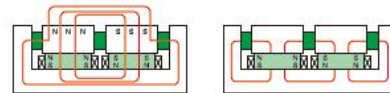
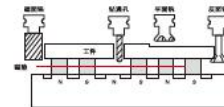

### 电控永磁回路图

只有在开关的过程中，电控永磁吸盘才使用电源，然后完全保持在“开”或“关”的位置。使用过程中不产生热，稳定性很好在托盘和方箱上装卸自由。灵活性极好，安全。不会由于断电使磁夹劲丧失。

Permanent magnetic disk in electric-control design, 2 seconds for charge, either no continuous electric supply, no temperature rise and no changeable on the workpiece.

HY50系列 50×50毫米方型磁极  
50\*50mm block magnetic pole

规格 Standard	A (mm)	B (mm)	C (mm)	自重 (千克) Weight(kg)	极数 (个) Pole NO.(pc)
HY50-2050	240	450	69	58	18
HY50-2060	240	630	69	81	24
HY50-2080	240	780	69	101	30
HY52-20100	240	930	69	120	36
HY50-3030	300	300	69	48	16
HY50-3040	330	360	69	64	20
HY50-3050	300	450	69	73	24
HY50-3060	300	630	69	102	32
HY50-3080	300	780	69	126	40
HY50-30100	300	930	69	150	48
HY50-4050	420	450	69	102	36
HY50-4060	420	630	69	142	48
HY50-4080	420	780	69	176	60
HY50-40100	420	930	69	210	72
HY50-5050	480	450	69	116	42
HY50-5060	480	630	69	163	56
HY50-5080	480	780	69	202	70
HY50-50100	480	930	69	240	84
HY50-6060	600	630	69	203	72
HY50-6080	600	780	69	252	90
HY50-60100	600	930	69	300	108

HY70系列 70×70毫米方型磁极  
70\*70mm block magnetic pole

规格 Standard	A (mm)	B (mm)	C (mm)	自重 (千克) Weight(kg)	极数 (个) Pole NO.(pc)
HY70-3040	300	410	69	66	12
HY70-3060	300	600	69	97	18
HY70-3080	300	790	69	128	24
HY70-30100	300	980	69	158	30
HY70-4040	380	410	69	84	16
HY70-4060	380	600	69	123	24
HY70-4080	380	790	69	162	32
HY70-40100	380	980	69	200	40
HY70-5060	460	600	69	149	30
HY70-5080	460	790	69	196	40
HY70-50100	460	980	69	243	50
HY70-6060	620	600	69	200	42
HY70-6080	620	790	69	264	56
HY70-60100	620	980	69	327	70

Note: 本样本所列规格数据如有变更, 恕不另行通知!  
If the data of specifications listed in this catalog has any change, forgive without prior notice!

浮动磁垫

浮动磁垫对于粗糙或变形表面的吸夹有独特方法。  
磁垫由2块45钢块组成。在吸盘消磁状态下颌工件自然接触, 一旦充磁, 它们可以吸住工件, 并处于定位状态而不变形。  
因此, 弯板可以在没有内应力的舒展状态下进行平面和台阶的加工。加工好的弯板在加工后不变形!

Floating magnetic pad for coarse or deformation on the surface of the clip has a unique absorption method.  
Magnetic pad consists of 2 piece of 45 steel piece. Degaussing state in chuck jaw workpiece contact nature, magnetization, once they can absorb the workpiece, and in the positioning state without deformation.

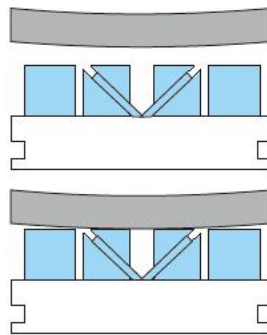

电磁吸盘控制器 (充退磁控制器, 整流器)

产品性能:

电磁吸盘控制器 (充退磁控制器, 整流器) 输入电压为交流电220V或380V, 直流输出电压0--110V可调, 电流容量2-25A, 退磁时间2--30秒可调, 工件剩磁在千分之一以下, 并且有对机床起保护作用的连锁装置。常年备有350W\500W\1000W\2000W\2500W电磁吸盘控制器 (充退磁控制器, 整流器), 能有效防止铣削刀磁化, 最适合“矩形标准电磁吸盘”和“铣削用强力电磁吸盘”配套使用。

Electro-Magnetic Chuck Controller (filled demagnetion controller, rectifier)

Product performance

Input voltage AC 220V or 380V, DC output voltage 0-110V, current capacity of 2-25A, demagnetization time of 2-30 seconds, Perennial with 350W, 550W, 1000W, 1500W, 2000W, 2500W Electro-Magnetic Chuck Controller (filled demagnetization controllers, rectifiers), can effectively prevent the milling cutter magnetization, most suitable for "standard rectangular electromagnetic sucker" and "strong electromagnetic sucker".